

JAMB SCREW INSTALLATION

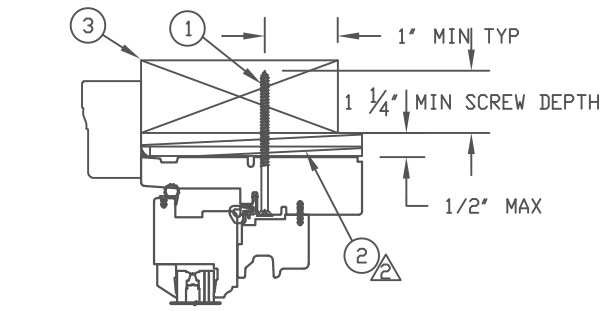

HEADJAMB

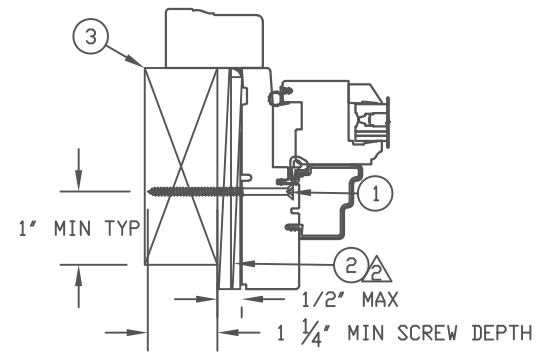

JAMB

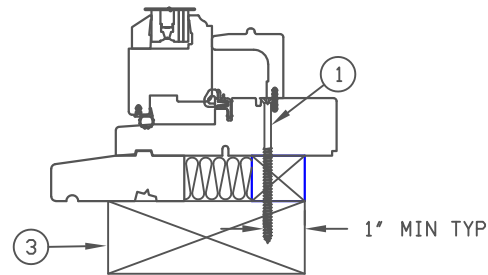

SILL

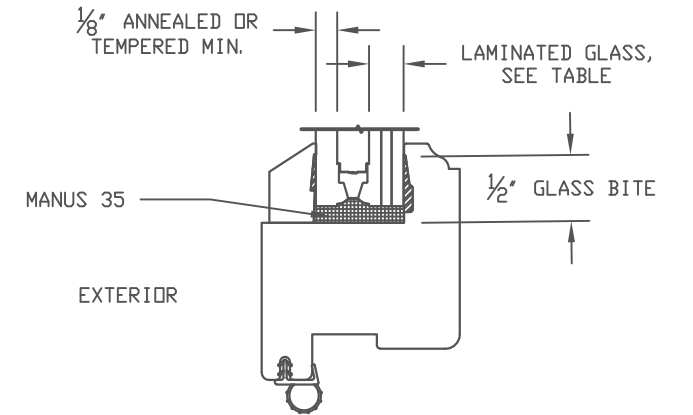
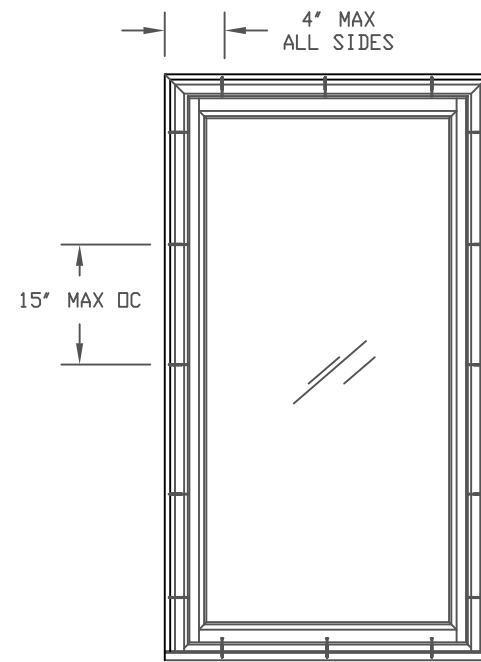

GLAZING DETAIL

JAMB SCREW INSTALLATION METHOD:

- UNIT MUST NOT BE IN DIRECT CONTACT WITH EITHER CONCRETE OR TREATED BUCK MATERIAL. IF SHIM SPACE IS LESS THAN 1/8" WRAPPING THE UNIT ON ALL 4 SIDES WITH WINDOW FLASHING TAPE IS REQUIRED AS A BARRIER BETWEEN THE UNIT AND CONCRETE OR TREATED LUMBER.
- SECURE JAMBS, HEADJAMB, & SILL WITH #8 X 3" SCREWS.
- SHIM AT EACH SCREW LOCATION.

UNIT	MAX FRAME SIZE	DP RATING	GLASS OPTION
UL WD AWN IZ3	53 1/8 X 54 1/16	+65/-65	TYPE A

TYPE	LAMINATED GLASS MAKEUP
A	3.0mm(.122") ANN + .090KURARAY PVB + 3.0mm(.122") ANN

NOTES:  
 1. THIS PRINT IS FOR STRUCTURAL PERFORMANCE ONLY. FOR FLASHING & SEALING INSTRUCTIONS, REFER TO THE INSTALLATION INSTRUCTIONS.  
 2. SHIMS-PLACE A SHIM WITHIN 4-6 INCHES OF EACH CORNER AND SPACE ALL OTHERS EVENLY A MAXIMUM OF 15" APART.  
 3. IF CHEMICALLY TREATED LUMBER IS USED FOR BUCK MATERIAL, FASTENERS INTO THE BUCK MUST BE A MINIMUM OF 0.90 OZ/FT<sup>2</sup> ZINC HOT DIPPED GALVANIZED OR STAINLESS STEEL TYPE 304 OR 316.

**CATEGORY:**  
CASEMENT

**UNIT TYPE:**  
UWAWN IZ3

ITEM NO	REF NO	DESCRIPTION
3	-----	WOOD BUCK BY OTHERS
2	-----	SHIM
1	-----	#8 X 3.000 WOOD SCREW

UNSPECIFIED TOLERANCES

DECIMALS: XX ± .03 XXX ± .012	ANGLE DEG: ± .5
LINEAL: + .125 - .000	FAB LINEAL: ± NA

MATERIAL:  
NA

**MARVIN** RESEARCH & DEVELOPMENT

COLLECTION: ULTIMATE

DWG TYPE: INSTALLATION  
DESCRIPTION: INSTALLATION

CHK:	SIZE: B	CLASS: MISC	DWG NO: 00068068
APP:	SCALE: NA	DATE: 03/08/10	DWG BY: BORNEMAN, SKIP
			SHEET: 1 OF 1